

New Mexico Rio Grande
SGNA Chapter #66



2021 Registration Form

Name: _____

Credentials: _____

Home Address: _____

City: _____

State/Zip: _____

Telephone: _____

Email: _____

Employer: _____

Employer Address: _____

Please send your check with copy of
current SGNA membership card &
registration form to:

Rachel Timmerman
2021 NM Rio Grande SGNA Chapter
President
5910 Laurel Court
Farmington, NM 87401

Questions: nmsgna1@gmail.com

Isleta Casino & Resort

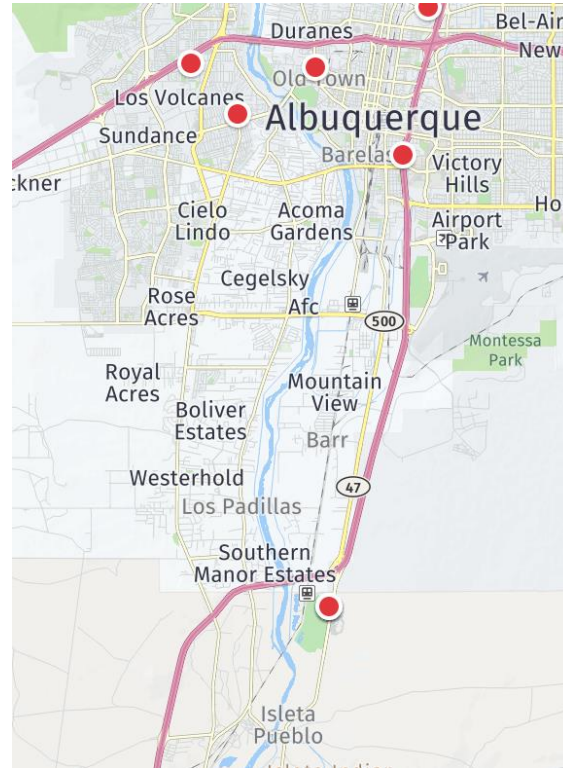

Directions

- From I-25 North head south to exit 215. Isleta Casino & Resort is on the left side of road.
- From I-25 South head north to exit 215. Isleta Casino & Resort is on the right side of road
- Casino Address is **11000 Broadway Blvd. SE, Albuquerque, NM 87105**

**Society of
Gastroenterology
Nurses & Associates**
New Mexico Rio Grande Chapter

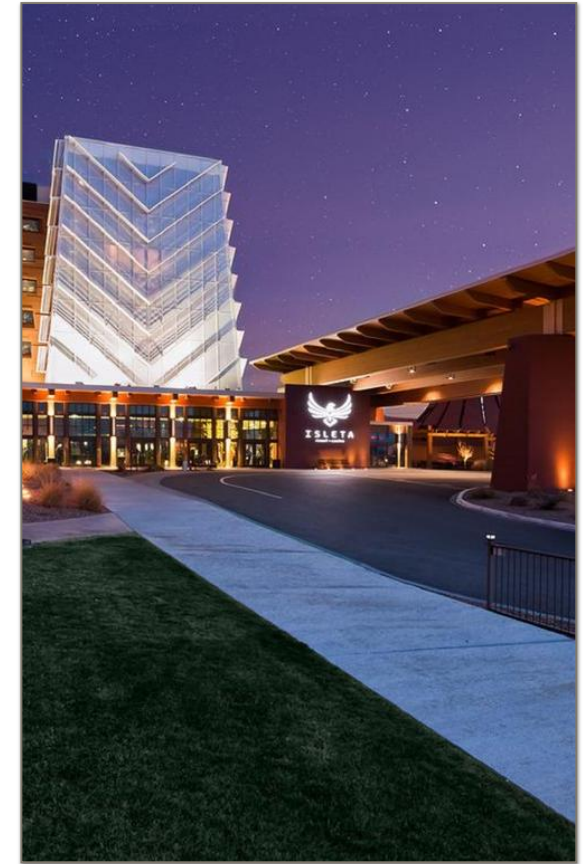

November 6, 2021

Conference Registration

\$65 SGNA Nurse Member
\$75 Non-Member Nurse
\$45 SGNA Tech Member
\$50 Non-Member Tech
\$30 Administrative Staff

Mail in registration by 11/01/2021 or use
Online registration available until
11/03/2021/2019 @ NMSGNA.ORG

***Door Registration will be an additional
\$15.00**

Please address check to:

NM Rio Grande SGNA Chapter #66

**Reserve discounted rooms at Isleta
Casino by using code GN21121**

Cut off date October 6, 2021

Call (505)747-5382 or (505) 848-1999



New Mexico Rio Grande SGNA Purposes the following:

- to unite persons engaged in any capacity in the fields of gastroenterology and/or endoscopy nursing;
- to provide educational programs for persons in such fields
- to advance the technology, science and arts of practitioners in such fields;
- to advocate optimal care for patients with digestive disease and those undergoing diagnostic and therapeutic procedures
- to cooperate with other professional societies, corporations and governmental bodies involved in such fields.

Conference Agenda

730-800 Catered Breakfast/Networking

800-900 **Euriko Torrazza-Perez, MD**

- Hepatobiliary Disease

910-1010 **Morgan Wong, MD**

- Pancreatic Cancer

1010-1030 Break/Networking

1030-1130 **Antonio Mendoza Ladd, MD**

- Peroral Endoscopic Myotomy

1130-1230 **Archana Kaza, MD**

- Motility & Manometry Use in Gastroenterology

1230-1330 Catered Lunch/Time with Exhibitors

1335-1435 **Sameen Khalid, MD**

- Colorectal Cancer Screening & Surveillance

1440-1450 Break

1450-1550 **Terra Wubbenhorst, MD**

- Anesthesia Consideration in Endoscopy

1600-Evaluation

1605-1655 **Cheri**

- Infection Control Practices in Endoscopy

Provider of CNE Event: NM Rio Grande SGNA Region

There is no commercial support for this CNE event.

This activity has been submitted to NMNA Education for approval to award contact hours. The NMNA is accredited as an approver of nursing continuing professional development by the American Nurses Credentialing Center's Commission on Accreditation.